

# 1955 - 1959 Corvette: Chevrolet PartSmart: Distributors and Starter Motors

---

Below is a copy of Chevrolet PartSmart from January 1958 showing part numbers and exploded views of the 1955 - 1959 Corvette distributor ignition and starter motor - solenoid switch.

# TECHNICAL INFORMATION

# Exploded

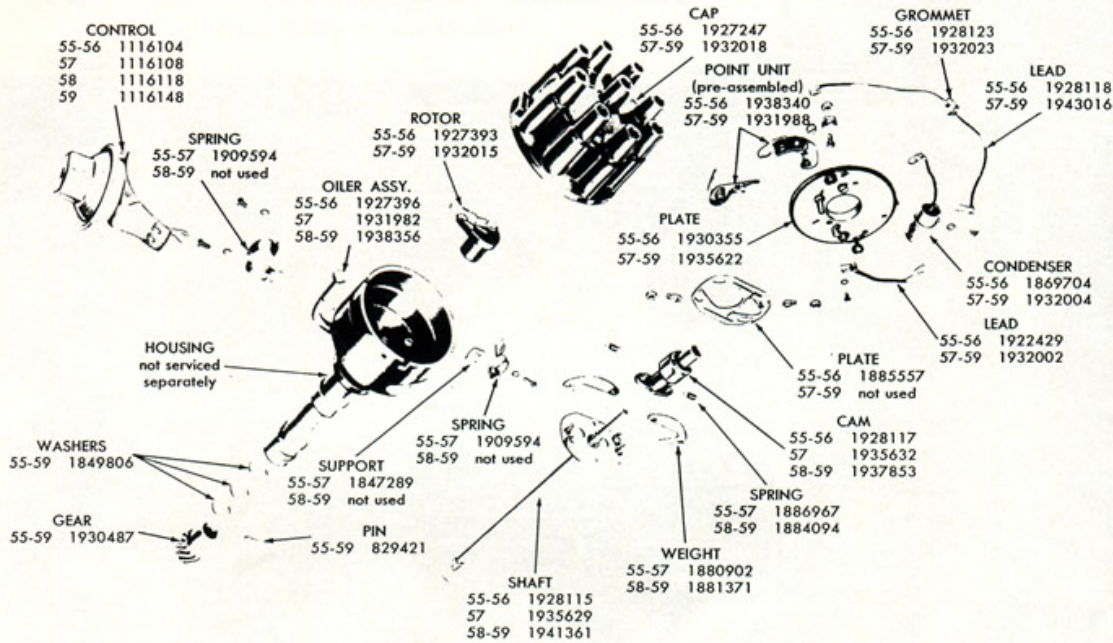

Unidentified items are standard parts

1955-1959 EIGHT CYLINDER IGNITION DISTRIBUTOR (TYPICAL)

(Standard 283)

Views with Part Numbers - TO HELP YOU!

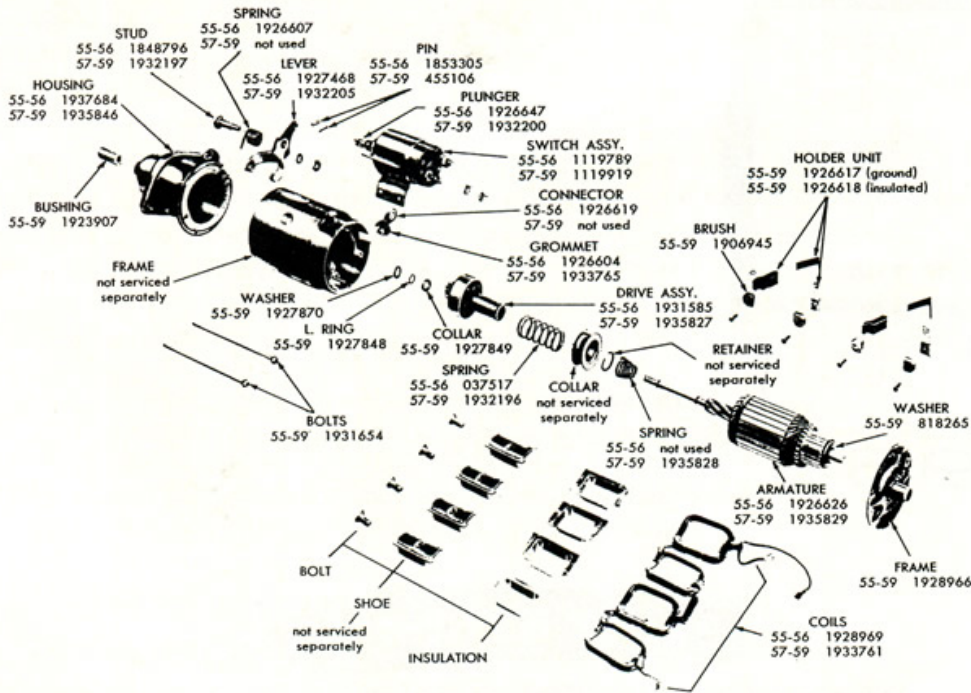

UNIDENTIFIED ITEMS ARE STANDARD PARTS

1955-59 STARTING MOTOR-SOLENOID SWITCH (TYPICAL)

Standard Eight Cylinder (283)

Online URL:

<https://www.corvetteactioncenter.com/tech/knowledgebase/article/1955-1959-corvette-chevrolet-partsmart-distributors-and-starter-motors-1042.html>