

# 1997 - 1998 Corvette: Service Bulletin: Loose Lower Front Fascia Valance Panels

**Source:** Chevrolet Dealer Service Bulletin

**Number:** 73-15-12A

REVISION: 07/14/98 DIVS INVL 1 7

THIS BULLETIN IS BEING REVISED TO ADD 1998 VIN BREAKPOINT INFORMATION. PLEASE DISCARD CORPORATE BULLETIN NUMBER 73-15-12 (SECTION 10 - BODY)

**SUBJECT: LOOSE LOWER FRONT FASCIA VALANCE PANELS (INSTALL ADDITIONAL ADDITIONAL WASHERS)**

**MODELS:** 1997-98 CHEVROLET CORVETTE - BUILT PRIOR TO VIN BREAKPOINT W5127967

## **CONDITION:**

SOME OWNERS MAY COMMENT THAT THE LOWER FRONT FASCIA VALANCE PANELS APPEAR LOOSE.

## **CAUSE:**

THE ORIGINAL WASHERS ON THE BOLTS/SCREWS THAT ATTACH THE LOWER VALANCE PANELS TO THE FRONT FASCIA MAY HAVE WORKED THEIR WAY THROUGH THE HOLES IN THE VALANCE PANELS.

## **CORRECTION:**

ADD ONE ADDITIONAL LARGER FLAT WASHER, P/N 11500365, 25 MM O.D. BY 6.3 MM I.D. BY 2.5 MM THICK (1 IN. O.D. BY 1/4 IN. I.D. BY 3/32 IN. THICK) TO EACH OF THE EIGHT BOLTS/SCREWS (FOUR PER VALANCE PANEL) THAT ATTACH BOTH LOWER VALANCE PANELS TO THE FRONT FASCIA (SEE FIGURE 1). TIGHTEN BOLTS TO 7 N.M (62 LB IN).

**IMPORTANT:**

VEHICLES BUILT AFTER THE ABOVE LISTED VIN BREAKPOINTS HAVE VALANCE PANELS WITH A SMALLER HOLE DIAMETER AND NEW FASTENERS. AS A RESULT, IT IS NOT NECESSARY TO INSTALL ADDITIONAL WASHERS ON THESE VEHICLES.

**PARTS INFORMATION:**

PARTS QUANTITY REFLECTS THE NUMBER REQUIRED TO DO BOTH LEFT AND RIGHT LOWER VALANCES ON ONE VEHICLE.

P/N	DESCRIPTION	QUANTITY	PACKAGED	QUANTITY
-----	-------------	----------	----------	----------

11500365	WASHER 8	1		
----------	----------	---	--	--

PARTS ARE CURRENTLY AVAILABLE FROM GMSPO.

**WARRANTY INFORMATION:**

FOR VEHICLES REPAIRED UNDER WARRANTY, USE:

LABOR OPERATION	LABOR OPERATION NUMBER	DESCRIPTION	TIME
-----------------	------------------------	-------------	------

B0392	AIR VALANCE, RIGHT	0.3 HR AND LEFT SIDE - REPLACE	
-------	--------------------	--------------------------------	--

**Figure 1**

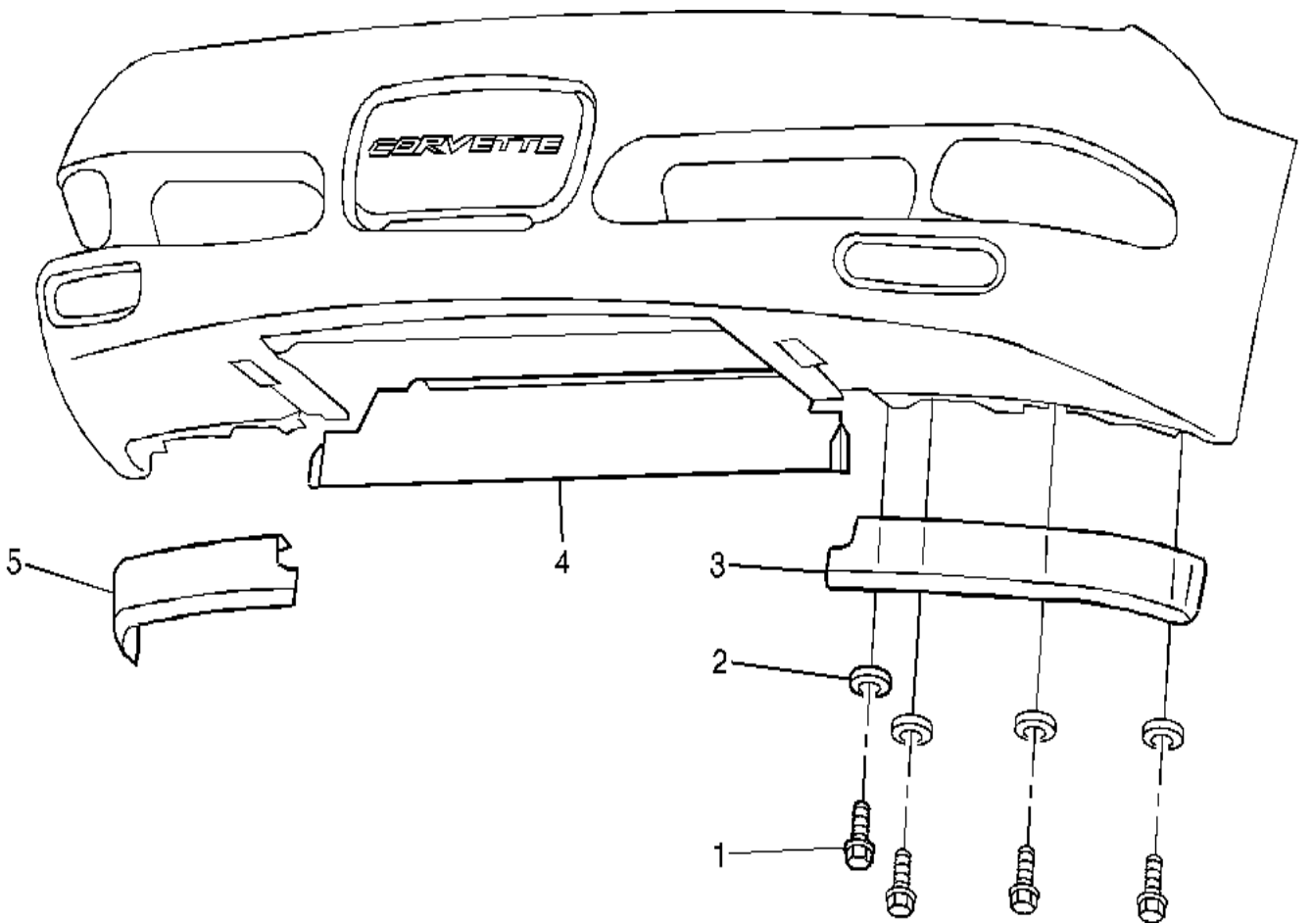

GM bulletins are intended for use by professional technicians, NOT a "do-it-yourselfer". They are written to inform these technicians of conditions that may occur on some vehicles, or to provide information that could assist in the proper service of a vehicle. Properly trained technicians have the equipment, tools, safety instructions, and know-how to do a job properly and safely. If a condition is described, DO NOT assume that the bulletin applies to your vehicle, or that your vehicle will have that condition. See your GM dealer for information on whether your vehicle may benefit from the information.

**COPYRIGHT 1997 GENERAL MOTORS CORPORATION. ALL  
RIGHTS RESERVED**

Online URL:

<https://www.corvetteactioncenter.com/tech/knowledgebase/article/1997-1998-corvette-service-bulletin-loose-lower-front-fascia-valence-panels-471.html>