

1964 Corvette: Service Bulletin: Directional Signal Switch Service

Model Year: 1964 All Series Except Corvette and Comfortilt Wheel

Subject: Directional Signal Switch Service

Source: Chevrolet - Central Office - Technical Service Bulletin

Bulletin No: DR #693, Section XII

Date: September 8, 1964

TO: ALL CHEVROLET DEALERS

A new design, all plastic directional signal switch assembly has been used since the start of 1964 production in subject vehicles. Two versions of the basic switch design cover all the various vehicle applications.

Both version of the new switch design may be serviced with individual parts as outlined in this bulletin. This will permit component parts replacement in many cases that previously required replacement of the complete switch.

When possible, component parts should be used to repair a switch rather than installing a complete switch assembly. This practice will not only result in a savings in parts cost, but usually reduces the service time involved since complete switch and harness removal is not always required.

A third type of switch assembly is used optionally on Chevelles. This switch is a die cast metal design, identified by cast letters "BPC", and is serviced only as an assembly, Part Number 383033. It is interchangeable with the plastic service switch 910372 only if housing 383688 or 383689 housing is also used.

Refer to the following pages of this bulletin for parts and service details.

SERVICE INFORMATION

The following service details apply in general to all vehicle series and all transmission control systems. Refer to the appropriate shop manual for specific model details.

1. Diagnose the problem as one that involves the directional signal switch, and eliminate other possible causes before removing the steering wheel (See attached "Trouble Shooting" guide).
2. Disconnect battery and remove the steering wheel per Shop Manual Instructions. On Chevelle Models, remove the retainer, spring and cancelling cam.
3. Remove the directional signal operating lever.
4. Remove the three (3) switch retaining screws and lift the switch enough to disengage the shifter tube housing.
5. Follow shop manual procedures of disassembly until the switch harness can be pulled out far enough to gain access to the actuating plate screw and remove the screw and actuating plate.

Any of the following components may be replaced without complete switch replacement; cancelling cam, actuating plate, upper mast jacket bearing and contactor kit.

"TROUBLE SHOOTING GUIDE"

COMPLAINT	DIAGNOSIS	CORRECTIVE ACTION
Either or both stop lights inoperative (bulbs and wiring check O.K.)	<ol style="list-style-type: none"> 1. Bent switch contacts 2. Open circuit in turn signal harness. 	<ol style="list-style-type: none"> 1. Replace switch contacts 2. Repair harness or replace switch assembly.
One directional signal (one side) inoperative (bulbs check O.K.)	<ol style="list-style-type: none"> 1. Bent switch contacts 2. Open circuit in wiring 	<ol style="list-style-type: none"> 1. Replace switch contacts 2. Repair or replace as necessary
Neither directional signal operative (bulbs and flasher check O.K)	<ol style="list-style-type: none"> 1. Bent switch contacts 2. Broken contact operating arm on actuating plate 3. Open circuit in flasher wiring 	<ol style="list-style-type: none"> 1. Replace switch contacts 2. Replace actuating plate 3. Repair or replace as necessary
No cancel	<ol style="list-style-type: none"> 1. Actuating plate broken or worn 2. Cancelling cam broken or worn 3. Tight pivot shaft 	<ol style="list-style-type: none"> 1. Inspect actuating plate - replace if nec. 2. Inspect cam - replace if necessary 3. If Item 1 and 2 appear satisfactory, install new actuating arm. (Be sure arm is properly lubricated).
Over cancel	<ol style="list-style-type: none"> 1. Detent springs not properly contacting arms 	<ol style="list-style-type: none"> 1. Replace actuating plate or switch assembly as necessary.

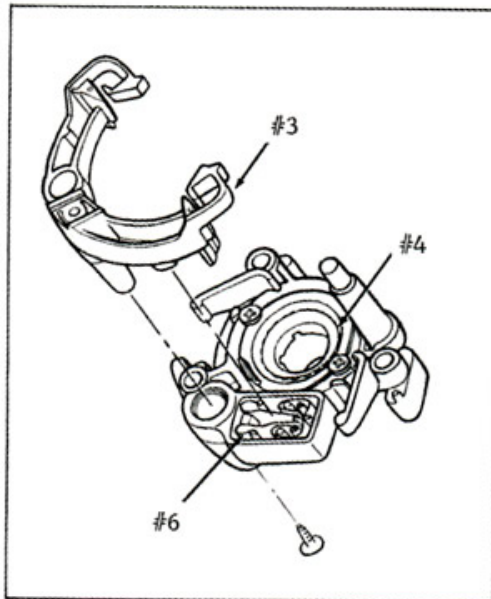

1964 CHEVELLE ONLY

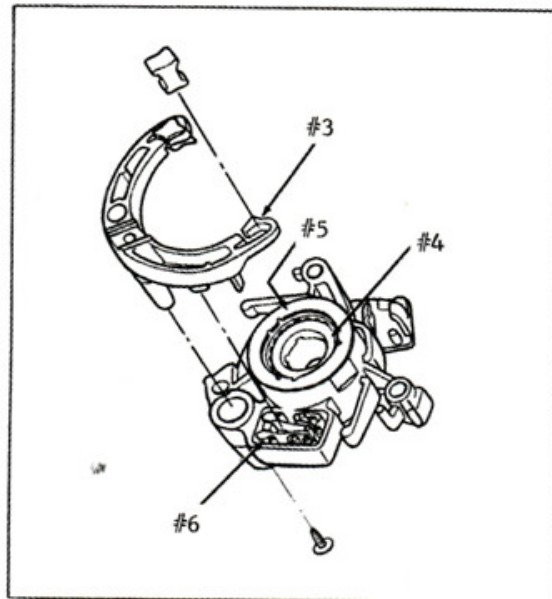

ALL 1964 EXCEPT CHEVELLE

DESCRIPTION AND PART NUMBERS		1000 SERIES	CHEVY II	10-30 TRUCK	50-80 TRUCK	CORVETTE	CHEVELLE	CORVAIR 95	CHEVY VAN
1.	CANCELLING CAM (Not shown) 3813945 382931	X		Exc. D.D.			X		
	3831338		X		X				X
	3841844					X			
	3857036							X	
2.	SWITCH ASSEMBLY (All parts shown) 910746	X	X	X		X		X	X
	910372 (383033 Optional)						X		
	910582			20-30 D.D.	X				
3.	ACTUATING PLATE 5955189 5955238	X	X	X	X	X	X	X	X
4.	UPPER MAST JACKET BEARING 5955201 383871	X	X	X	X	X	X	X	X
5.	HORN CONTACT RING 5955202	X	X	X		X		X	X
6.	CONTACTOR KIT (Spring Unit) 5955856	X	X	X	X	X	X	X	X

FLAT RATE DATA

<u>Operation</u>	<u>Time</u>	<u>Description</u>
12M-8130	Refer to the 1964 Flat Rate Schedule for Specific Model	Switch, Directional Signal - Replace (Use this operation for remove and reinstall)
Time Combination	.2 Hr. (All Models)	Switch, Directional Signal - Overhaul

Online URL:

<https://www.corvetteactioncenter.com/tech/knowledgebase/article/1964-corvette-service-bulletin-directional-signal-switch-service-886.html>