

1963 - 1967 Corvette: Service News: Adding Hardtop to Corvette Convertibles

Subject: Adding Hardtop to Corvette Convertibles

Model and Year: 1963 - 1967 Corvette Convertible

Source: Chevrolet Service News

Page Number: 4

Date: May, 1964, Volume 36, Issue Number 5

Adding Hardtop To Corvette Convertibles

If an owner desires, a hardtop can easily be added to any 1963-64 Corvette Convertible (Model 867) that was delivered from the factory without this option. Roof Panel Assembly, Part #3838439, (unpainted and complete with hardware) is available thru regular Chevrolet Parts channels.

The only other parts required for installation are two plastic retainers (same as used on Corvair and Chevrolet door inner panels for trim panel retention). These plastic parts are first modified and then positioned on the hardtop at the rear bow bolt retaining location, as shown in Figure 2.

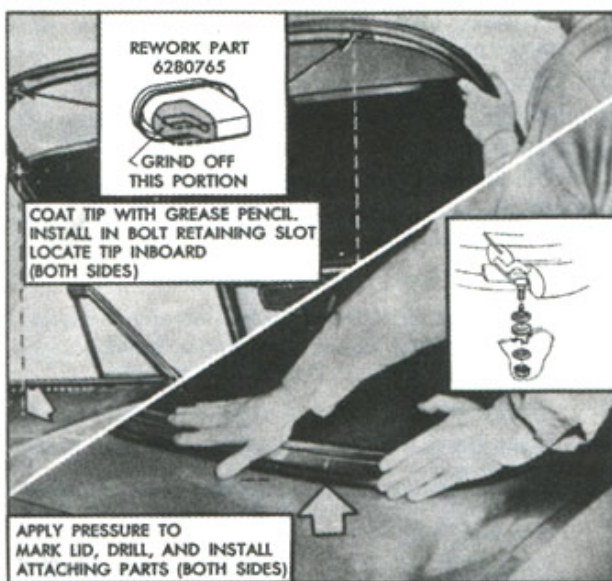

Fig. 2 — Hardtop Attachments at Rear

The tips of the plastic parts are rubbed with a china marker pencil and the roof panel is lowered into position on the vehicle to transfer the pencil markings to the surface of the convertible folding top compartment lid. This marks the location for drilling of two bolt holes in the lid.

The roof panel assembly is then used as a template to mark and drill two lock pillar area holes (one each side) as shown in Figure 3. The hardware is then attached at the above four locations and the header latches secured.

A detailed description of the above installation is provided below:

1. Rework the two Plastic Retainers (#6280765), as shown by figure 2.
2. Slide the modified plastic retainers into the bolt retaining slots in the hardtop rear bow (the tip section remaining on the plastic card should be located inboard end of slot).
3. Mark the hardtop reveal molding at the

approximate location of the two plastic retainers.

4. Mark the tips of the two plastic retainers with a china marker pencil.

NOTE: Make certain that the folding top compartment lid is free of dirt and wax.

5. Close the top compartment lid.
6. With aid of an assistant, position hardtop windshield into header and lower the hardtop onto vehicle. Do not fasten latches at windshield header.

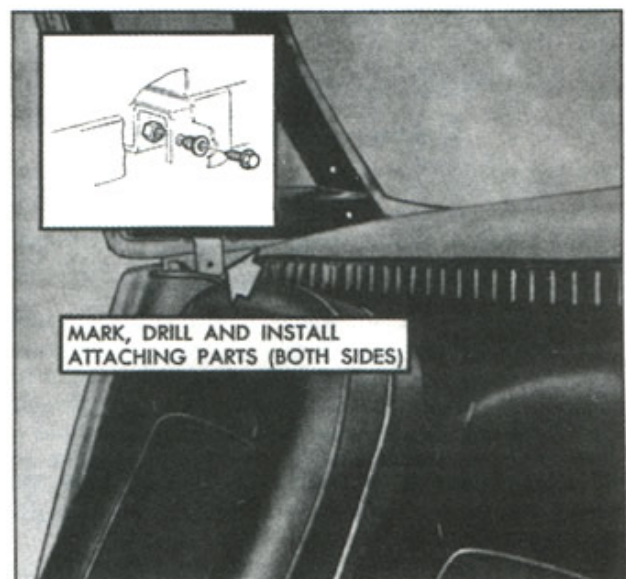

Fig. 3 — Hardtop Attachments at Sides

7. Apply hand pressure at reveal molding marks.
8. Mark roof panel attachment hole location at each lock pillar area.
9. With aid of an assistant, lift roof panel straight up off body and set roof panel aside.
10. Mark the drill position at the four china marks with a center punch.
11. Place a 2" x 4" board under the top compartment lid to prevent drill damage to folding top material. Make certain the compartment lid is securely locked before drilling.
12. Drill 1/8" pilot hole at the 4 marked locations.
13. Drill 1/2" hole at pilot hole locations.
14. Insert ferrules furnished for holes drilled in top compartment lid. Crimp ferrule tabs.
15. With aid of an assistant, place the hardtop onto the vehicle and install attaching parts at all four locations. Lock latches at windshield header.

Online URL:

<https://www.corvetteactioncenter.com/tech/knowledgebase/article/1963-1967-corvette-service-news-adding-hardtop-to-corvette-convertibles-889.html>